



INSTALLATION AND OPERATING MANUAL

READ THESE INSTRUCTIONS COMPLETELY BEFORE INSTALLING THE PRODUCT. FOR PRODUCT OR INSTALLATION QUESTIONS PLEASE CALL CUSTOMER SERVICE AT 1-800-221-3379.

YOU MUST FOLLOW ALL INSTRUCTIONS IN THIS MANUAL: FAILURE TO DO SO WILL RESULT IN YOUR ASSUMPTION OF LIABILITY AND WILL VOID WARRANTY AND CAN RESULT IN PRODUCT DAMAGE OR PERSONAL INJURY.

FAILURE TO USE A SUITABLE SETTING COMPOUND WILL VOID THE WARRANTY.

THIS PRODUCT IS DESIGNED TO BE INSTALLED BY A LICENSED TRADESMAN. LICENSED PLUMBERS AND ELECTRICIANS SHOULD BE EMPLOYED TO INSURE PROPER INSTALLATION. INSTALLERS ASSUME ALL LIABILITY FOR THE CORRECT INSTALLATION PROCEDURES.

Only accessories authorized by the manufacturer should be used with this product. This product is designed for residential use and use by healthy individuals.

IMPORTANT SAFETY INSTRUCTIONS: **WARNING!** WHEN USING THIS PRODUCT, BASIC PRECAUTIONS SHOULD ALWAYS BE FOLLOWED. READ AND FOLLOW ALL INSTRUCTIONS PERTAINING TO RISK OF FIRE, ELECTRIC SHOCK, OR INJURY TO PERSONS.

INSTALLER: LEAVE THIS MANUAL FOR HOMEOWNER.
HOMEOWNER: READ THIS MANUAL AND KEEP FOR FUTURE REFERENCE.

TABLE OF CONTENTS

Important Safety Information	1
Recommended Tools and Material	2
Inspection & Testing	2
Electrical Requirements & Information	3
Framing & Installation	5
Rough-in Dimensions	7
Care & Cleaning/Maintenance	9
Operating Instructions	9
Troubleshooting	12
Warranty	12
Cut-Out Templates	13



WARNING

IMPORTANT SAFETY INSTRUCTIONS

SAVE THIS MANUAL: RETAIN FOR CONSUMER'S USE. READ THESE INSTRUCTIONS COMPLETELY BEFORE INSTALLING THE PRODUCT: FOR PRODUCT OR INSTALLATION QUESTIONS PLEASE CALL CUSTOMER SERVICE AT 1-800-221-3379.

YOU MUST FOLLOW ALL INSTRUCTIONS IN THIS MANUAL: FAILURE TO DO SO WILL RESULT IN YOUR ASSUMPTION OF LIABILITY AND WILL VOID WARRANTY AND CAN RESULT IN PRODUCT DAMAGE OR PERSONAL INJURY. FAILURE TO USE A SUITABLE SETTING COMPOUND WILL VOID THE WARRANTY.

THIS PRODUCT IS DESIGNED TO BE INSTALLED BY A LICENSED TRADESMAN. LICENSED PLUMBERS AND ELECTRICIANS SHOULD BE EMPLOYED TO INSURE PROPER INSTALLATION. INSTALLERS ASSUME ALL LIABILITY FOR THE CORRECT INSTALLATION PROCEDURES.

Only accessories authorized by the manufacturer should be used with this product.

This product is designed for residential use and use by healthy individuals.

WARNING

IMPORTANT SAFETY INSTRUCTIONS

WHEN USING THIS PRODUCT, BASIC PRECAUTIONS SHOULD ALWAYS BE FOLLOWED. READ AND FOLLOW ALL INSTRUCTIONS PERTAINING TO RISK OF FIRE, ELECTRIC SHOCK, OR INJURY.

WARNING

IMPORTANT SAFETY INSTRUCTIONS

INSTRUCTIONS PERTAINING TO A RISK OF FIRE, ELECTRIC SHOCK OR INJURY TO PERSONS READ AND FOLLOW ALL INSTRUCTIONS!

WARNING

Risk of personal injury. Do not permit children to use this unit without adult supervision.

WARNING

Risk of personal injury. Do not operate this unit without the guard over the suction fitting.

WARNING

Risk of electric shock. Do not permit electrical appliances (hair dryer, telephone, radio, etc.) within 60 inches (1524mm) of this unit.

WARNING

Risk of hyperthermia and possible drowning. People using medications and/or having adverse medical history should consult a physician before using this product.

WARNING

Risk of personal injury. Do not overfill unit before entering. Entering tub when filled more than 2/3 can cause overflow and slippery conditions. Exercise caution when entering and exiting.

WARNING

No Food or Alcoholic Beverages. Use of your bathtub immediately after meals is not recommended. Avoid alcohol consumption before or during bathing. Alcoholic beverages can cause drowsiness or hyperthermia resulting in loss of consciousness or even drowning.

WARNING

Pregnancy. If you are or think you may be pregnant, consult your physician before using the bathtub. Never drop or insert any object into any opening. Use this unit only for its intended use as described in this manual. Do not use any attachments not recommended by Mirabelle.

This equipment is intended for indoor use only.

Important Safety Instructions

The unit must be connected only to a supply circuit that is properly protected by a 20 amp ground-fault circuit interrupter (GFCI). Such a GFCI should be provided by the installer and should be tested on a routine basis. To test the GFCI, push the test button. The GFCI should interrupt power. Push the reset button. Power should be restored. If the GFCI fails to operate in this manner, the GFCI is defective. If the GFCI interrupts power to the bathtub without the test button being pushed, a ground current is flowing, indicating the possibility of an electric shock. Do not use this total massage, whirlpool or air bathtub. Disconnect The total massage, whirlpool or air bathtub and have the problem corrected by a licensed electrician before using.

A pressure wire connector is provided on the exterior of the motor unit to permit connection of a no. 8 AWG solid copper bonding conductor between this unit and all other electrical equipment and exposed metal in the vicinity, as needed to comply with local requirements. To reduce the risk of an electric shock, connect this connector to the grounding terminal of your electric service or supply panel with a conductor equivalent in size to the circuit conductors supplying this unit. Use supply wires that are suitable for 167°F (75°C), including the temperature rating of the supply conductors to be used. Building materials and wiring should be routed away from the motor/pump or blower or other heat producing components of this unit.

Recommended Tools and Material

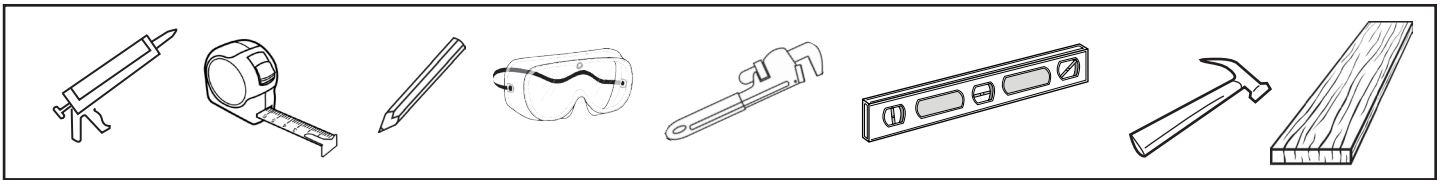

- Silicone sealant
- Tape measure
- Pencil
- Safety glasses
- Pipe wrench
- Level
- Conventional woodworking tools and materials
- Drop cloth
- 2x4's
- Mortar
- Optional: construction adhesive

Inspection and Testing

Each bath arrives ready for installation, completely equipped with the pump and plumbing necessary for operation. However, a drain/overflow kit is required for each bath and it is not included.

The variety of installations for this bath may require framing procedures other than those shown.

Locate studs as required. Ensure roughing-in dimensions (see pg. 11) are proper, plumb, and square.

Inspection:

- Remove the bath from the carton. Retain the shipping carton until satisfactory inspection of the product has been made. Do not lift the bath by the plumbing at any time; handle by the shell only. All bath units are factory tested for proper operation and watertight connections prior to shipping.
- Inspect the shell and bathtub components. Should inspection reveal any damage or defect in the finish or visible damage to any components, do not install the bathtub. **Damage or defect to the finish claimed after the bathtub is installed is excluded from the warranty.**
- Inspect the tub components for loose fittings.

Testing:

- Prior to installation and before enclosing with wallboard, tile, etc., the bath must be filled with water and operated to check for leaks that may have resulted from shipping damage or mishandling.
- It is the responsibility of the installer to thoroughly test the tub prior to completing installation. Place the tub on a level surface, ensure drain is sealed and fill the bathtub with water to the bottom of the overflow. Allow water to sit in tub for at least 5 minutes as a static test. If installing a system tub, plug in the motor/ pump and turn it on. Confirm all features function correctly. Visually inspect all joints for leaks.

DO NOT install tub if any leaks are detected or system functions do not work properly.

Electrical Requirements and Information

ALL CONNECTIONS MUST BE GFCI (Ground Fault Circuit Interrupter) PROTECTED

1. Whirlpool and Total Massage units require dedicated 20 Amp, 120V service.
2. You must provide a receptacle with a 20-amp configuration.
3. See local codes for proper wire size. If not specified, use #12 Copper only wire.
4. Optional In-Line Heater requires its own dedicated 20 amp service.

The unit must be connected to a circuit interrupter (GFCI) provided by the installer. The (GFCI) breaker should be tested on a routine basis.

To test the (GFCI) breaker, push the test button. The GFCI should interrupt power. To restore power, push the RESET button. If the GFCI fails to operate in this manner there is ground current flowing, indicating the possibility of an electrical shock. Do not use the unit. Disconnect the unit and have the problem corrected by a qualified service representative before using.

DANGER

RISK OF ELECTRICAL SHOCK. All pumps and blowers must be connected to a ground fault circuit interrupter (GFCI) protected outlets. Standard Line Total Massage units can be operated on a single service. All heaters must be connected to a ground fault circuit interrupter (GFCI) protected outlets, separate from the pump and/or blower.

DANGER

Electrical outlet must be mounted 4" (101mm) above the floor line and 12" max (305mm) inside from the edge of the bathtub, or in accordance with local building and electrical codes.

- Risks of component over heat. Do not use electric extension cord to power the unit. Operating the pump without enough water in bathtub can cause permanent damage to the pump/motor.
- If CFGI unit indicates a malfunction, per manufacturer's instructions, turn OFF power and do not attempt to use the bathtub until the source of the problem has been identified and corrected.

Electrical Configurations

WHIRLPOOL CIRCUIT WITH OPTIONAL HEATER

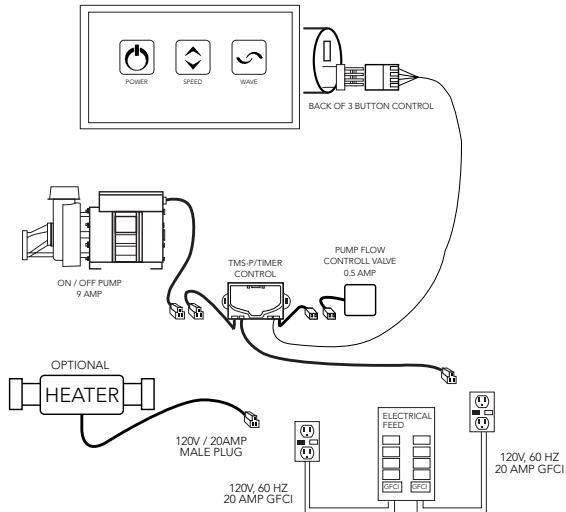

TOTAL MESSAGE CIRCUIT WITH OPTIONAL HEATER

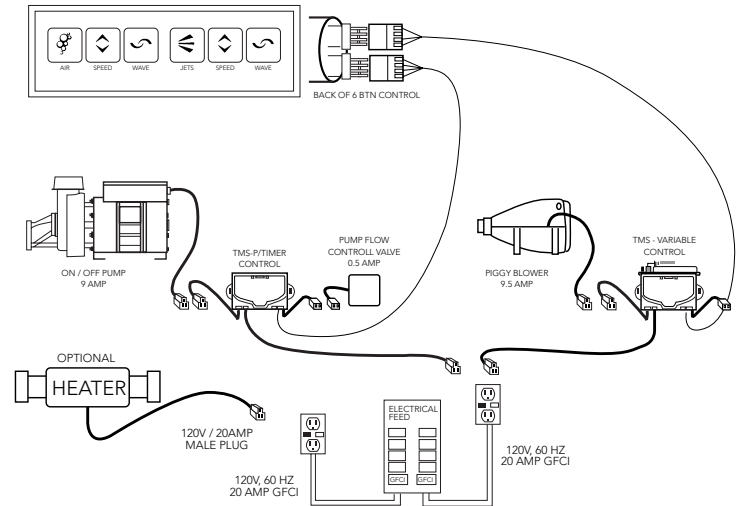

AIR MESSAGE CIRCUIT

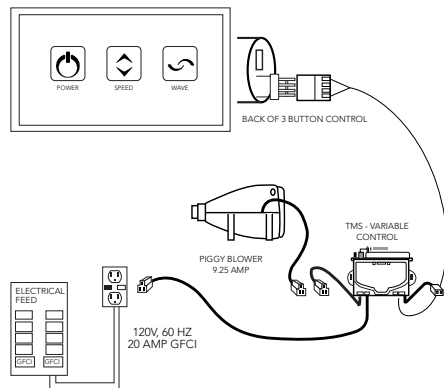

BRADENTON & PROVINCETOWN TOTAL MESSAGE CIRCUIT WITH OPTIONAL HEATER

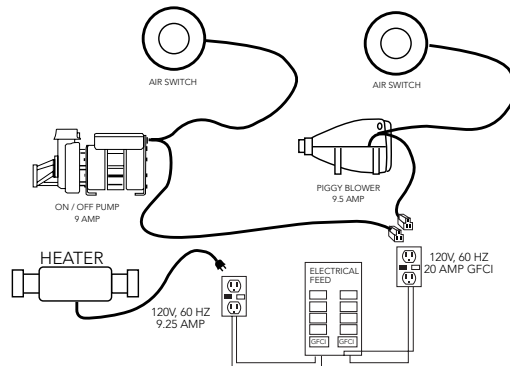

BRADENTON & PROVINCETOWN WHIRLPOOL WITH INSTALLED AIR SWITCH

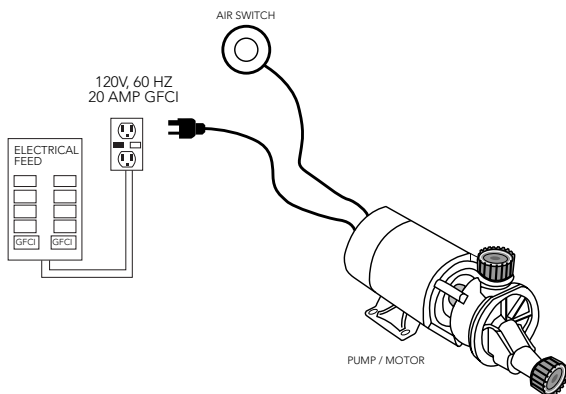

BRADENTON & PROVINCETOWN AIR BATH CIRCUIT

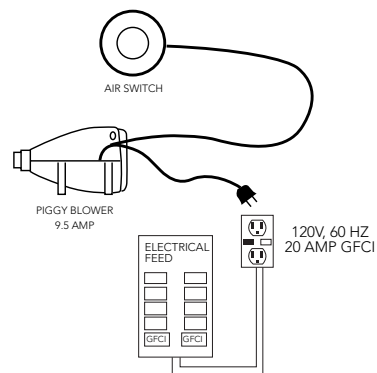

Framing and Installation

Structural measurements should be verified against the actual bath received to ensure proper fit.

- Never lift the tub by the plumbing. Doing so can result in leaks.
- Check if the floor is level and of good quality. An uneven floor may impede proper installation of the tub.
- Clean installation area of any debris or trash.

Locate studs as needed. Ensure roughing-in dimensions are proper, plumb and square. Provisions must be made in all installations for an access opening for servicing the pump and controls on the pump or blower side.

An access opening of at least 16" x 20" must be provided or warranty service will not be performed. It is strongly recommended that an additional opening be provided for access to the drain components. **The apron should not be used as the primary access opening.**

If the subfloor is not level, you must level the entire surface prior to installing the bathtub.

Ensure that the entire floor is level and can support a load of 50lbs. per square foot.

The bathtub must remain level in order for it to drain properly and must make contact with the leveling material.

1. Position the tub into the installation opening and level the deck in both directions, shimming the base of the tub if necessary. Mark the final position of the underside of the deck by tracing a line on to the studs (see Figure 1).
2. Remove the tub and attach a 1 x 4 stringer to the studs, with the top of the stringer touching the traced line. Never support the tub by its deck lip or stringers (see figure 2).
3. Install drain components to the tub following the drain installation instructions. Note that this requires a cutout in the floor. Before replacing your tub for final installation, bathtubs require a 6" x 12" floor opening for the 1-1/2" drain and waste & overflow kit. The drain/overflow of the bath extends below the bottom of the bath.

The bath must be supported along its entire bottom. Do not remove foam base & pad from the bottom of the tub. Use 1-1/2" to 2" of mortar as bedding material (do not use sand or foam). After the mortar has been poured, and before it sets, position tub within recess until the rim is leveled against the leveling stringers (see below).

FIGURE 1
STRINGER INSTALLATION

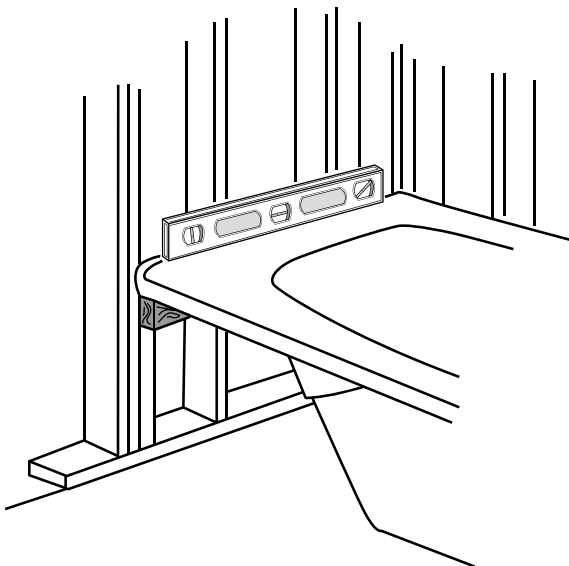
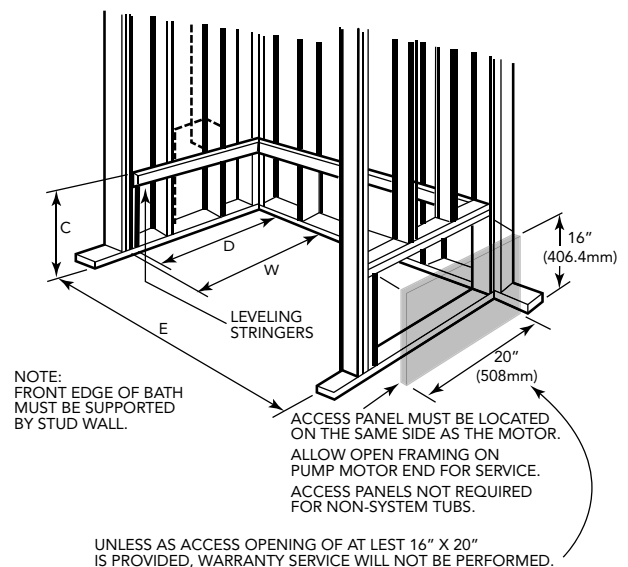
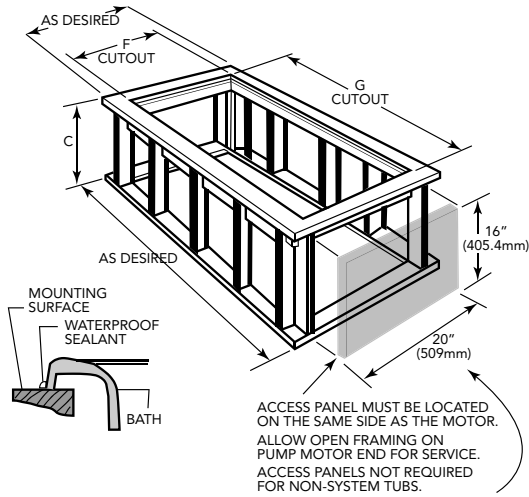

FIGURE 2
TYPICAL ALCOVE INSTALLATION



Framing and Installation

TYPICAL DROP-IN TYPE INSTALLATION



UNLESS AS ACCESS OPENING OF AT LEAST 16" X 20" IS PROVIDED, WARRANTY SERVICE WILL NOT BE PERFORMED.

REFERENCE FOR DROP-IN INSTALLATION

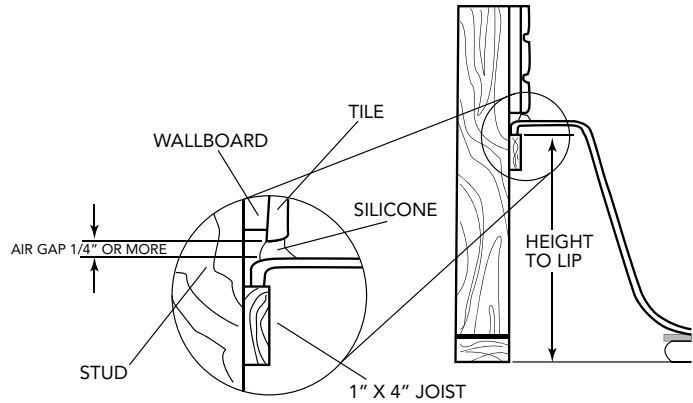

Reference for correct tile flange installation Use drawing below as a reference guide for rough-in measurements

SUGGESTED WHIRLPOOL/BATH INSTALLATION METHOD

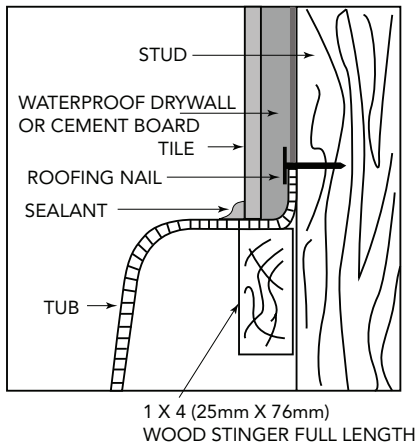

DRAIN CLEARANCE

PUMP ACCESS

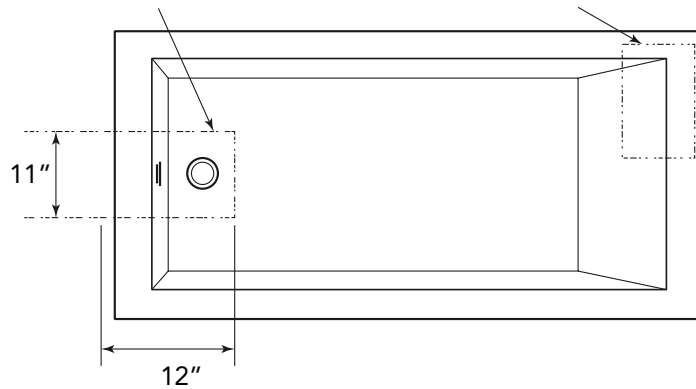

Allow the mortar material to completely harden before applying weight to the rim or bottom of the bath. Any finish material such as tile or wall board must be self supporting if it contacts the deck of the bath.

Verify that the product is level by checking the tub deck surface in all directions.

For system tubs ensure blower and or pump cords are properly plugged into the dedicated 120V/20A GFCI outlet to supply electrical power to the system (Please reference pg. 6) for electrical requirement information. To test run the bath, fill the tub with water at least 3" above the highest jet and operate the bath for 5 minutes. Check all bath and piping connections for leaks.

POST INSTALLATION CLEAN-UP

Remove all construction debris from bath. Do not use wire brushes or any other metal implement on bath surface.

Post installation clean-up generally can be completed using warm water and liquid dishwashing detergent.

Stubborn dirt or stains may be removed using granular Spic and Span® mixed with water. Painter's Naphtha can be used to remove excess adhesives and/or wet oil-base paint.

Rough-in Dimensions

Series	Soaker	Air	Whirlpool	Total Massage	L	W	D	H	A	B
Bradenton	MIRBDS6030 (L/R)	NA	NA	NA	59.75"	30"	18.88"	17.88"	11"	12"
Bradenton	MIRBDS6032	MIRBDA6032	MIRBDW6032	MIRBDT6032	60"	32"	20"	18.5"	11"	16"
Bradenton	MIRBDS6032 (L/R)	MIRBDA6032 (L/R)	MIRBDW6032 (L/R)	MIRBDT6032 (L/R)	60"	32"	21"	20"	11"	16"
Boca Raton	MIRBRS6640V	MIRBRA6640V	MIRBRW6640V	MIRBRS6640V	66"	40"	22"	20.5"	35.75"	10"
Boca Raton	MIRBRS7242V	MIRBRA7242V	MIRBRW7242V	MIRBRS7242V	71.5"	42"	22"	20.5"	35.75"	10"
Sitka	MIRSKS6030 (L/R)	MIRSKA6030 (L/R)	MIRSKW6030 (L/R)	NA	60"	30"	19.5"	19.25"	8.75"	15"
Sitka	MIRSKS6032 (L/R)	MIRSKA6032 (L/R)	MIRSKW6032 (L/R)	NA	60"	32"	19.5"	19.25"	8.75"	16"
Sitka	MIRSKS6032	MIRSKA6032	MIRSKW6032	NA	60"	32"	19.5"	18.5"	8.75"	16"
Sitka	MIRSKS6036	MIRSKA6036	MIRSKW6036	MIRSKT6036	60"	36"	23"	22"	8.75"	18"
Sitka	MIRSKS6636	MIRSKA6636	MIRSKW6636	MIRSKT6636	66"	36"	23"	22"	8.75"	18"
Sitka	MIRSKS7236	MIRSKA7236	MIRSKW7236	MIRSKT7236	72"	36"	23"	22"	8.75"	18"
Galatia	MIRGAS6042	MIRGAA6042	MIRGAW6042	MIRGAT6042	60"	42"	21"	19.5"	10.25"	21"
Galatia	MIRGAS7242	MIRGAA7242	MIRGAW7242	MIRGAT7242	72"	42"	21"	19.5"	10.25"	21"
Key West	MIRKWS6036	MIRKWA6036	MIRKWW6036	MIRKWT6036	60"	36"	22"	20.5"	9.5"	18"
Key West	MIRKWS7236	MIRKWS7236	MIRKWW7236	MIRKWT7236	72"	36"	22"	20.5"	8.25"	18"
Provincetown	MIRPRS6032 (L/R)	MIRPRA6032 (L/R)	MIRPRW6032 (L/R)	MIRPRT6032 (L/R)	60"	32"	21"	20"	9"	16"
Provincetown	MIRPRS6032	MIRPRA6032	MIRPRW6032	MIRPRT6032	60"	32"	20"	18.5"	9"	16"
St. Augustine	MIRSAS6042	MIRSAA6042	MIRSAW6042	MIRSAT6042	60"	42"	22"	20.5"	8.75"	30"
St. Augustine	MIRSAS7242	MIRSAA7242	MIRSAW7242	MIRSAT7242	70"	42"	22"	20.5"	8.5"	36"

Use drawing below as a guide for rough-in measurements

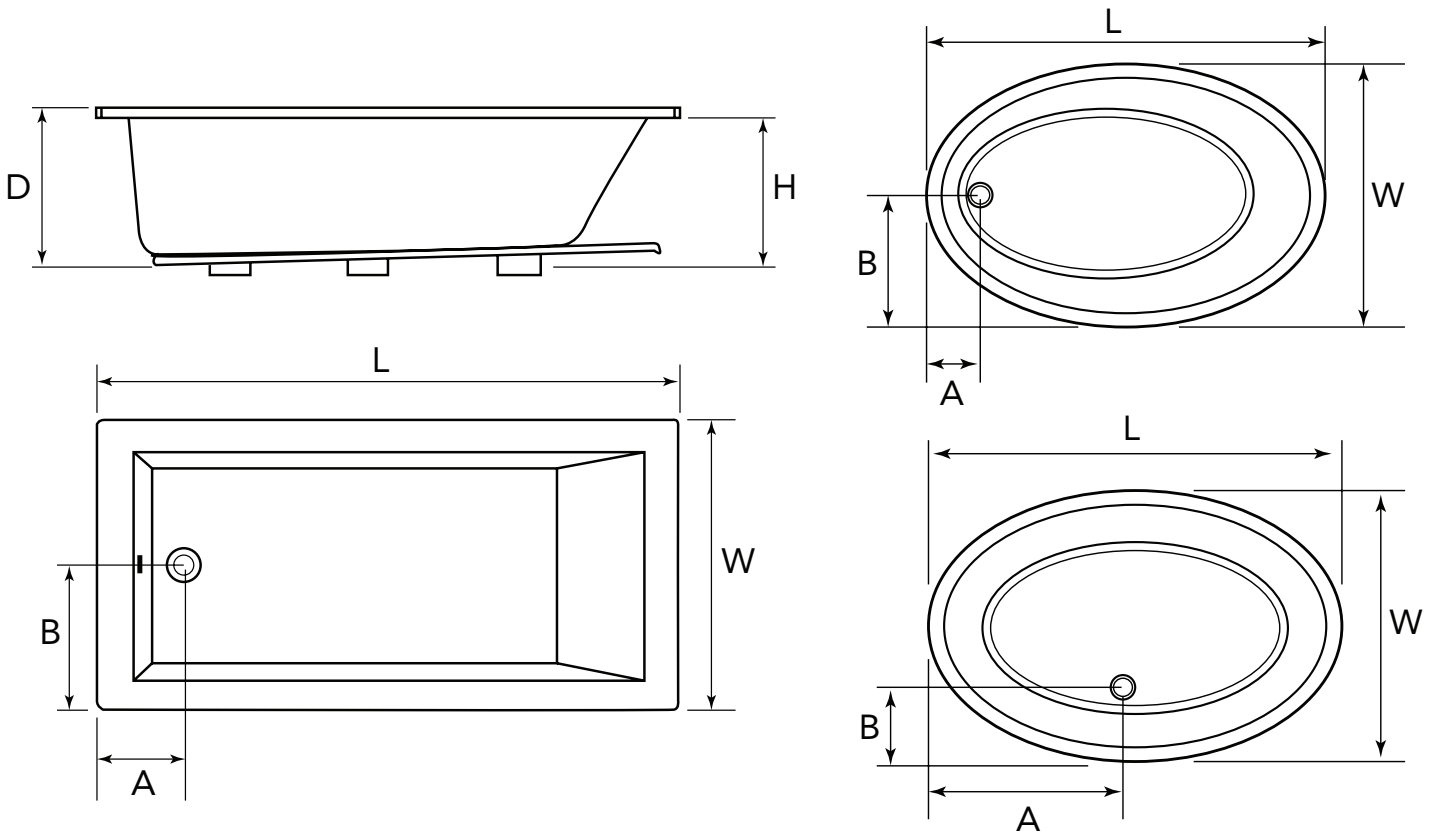

Deck-to-floor dimensions are measured through the drain hole to give a more consistent measurement. The dimensions are achieved by laying a straight edge across the deck; the distance was then measured from the floor at the drain opening to the bottom of the straight edge. (See illustration below). The lip height is then subtracted to give a more consistent floor to lip height. There may be height dimension variations of plus minus 1/4" from the stated dimension in the table, which is a standard production tolerance. Leave adequate clearance with framing for side mounted controls.

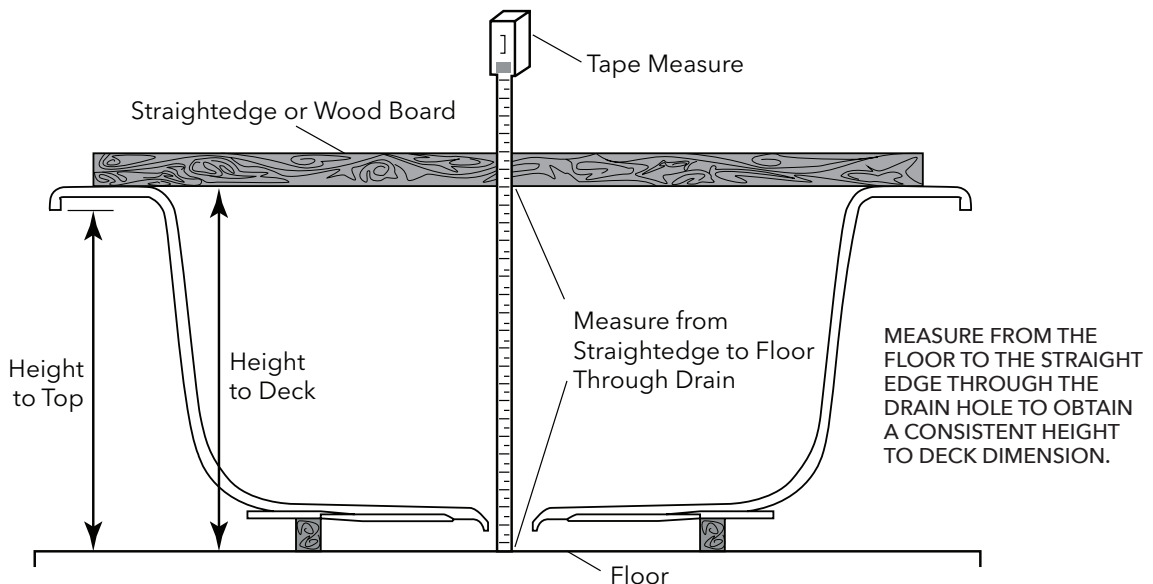

Care and Cleaning



The use of bath oils and bath salts is not recommended due to the difficulty in cleaning the systems and doing so will **void the consumer's warranty**.

Air and Total Massage Baths are equipped with an Automatic Purge Cycle for the air blower only. The air blower has a pre-programmed purge cycle built in to expel the remaining water in the air channels. It activates within 20 minutes after the Air Bath is turned off and then blows for about 2 to 3 minutes.

After the cycle is completed it will shut off automatically. There is nothing to be alarmed about if you hear a blowing noise coming from the tub after the tub has been turned off. The noise you hear is the cleaning cycle in operation. It is recommended to activate the air bath routinely to purge water from the air channel when tub is used as a soaker or shower only. Purge cycle is only activated when blower has been used.

Pump and pipe circulation system should be flushed before first use and on a monthly basis when product is under normal use.

Below are the recommended procedures for cleaning:

-  **DO NOT** use powdered cleaners unless cleaner is fully dissolved in water.
-  **DO NOT RUN WHIRLPOOL DRY.** Fill the tub with hot water 2-3 inches above the jets and add 2-3 teaspoons of low foaming detergent such as dish washing machine detergent.
-  **DO NOT** use full strength bleach or ammonia cleaning solutions. Chemically active cleaning solution can damage the bath surface.
 - Switch on whirlpool and run for 10 minutes.
 - Drain tub completely.
 - Fill tub with cold water above jets.
 - Switch on whirlpool and run for 5 minutes.
 - Drain tub completely.

 **DO NOT USE ABRASIVE CLEANERS** as they will scratch and dull the surface of the acrylic and **void the consumer warranty**. Plaster can be removed using a sharpened wooden stick.

 **DO NOT USE METAL SCRAPERS, WIRE BRUSHES OR OTHER HARSH ABRASIVE TOOLS.**

Usually a mild detergent will remove construction debris. More stubborn debris may be removed with denatured alcohol, or Clorox Soft Scrub® cleaner. Light scratches and dulled areas may be restored to original luster by rubbing with an automotive type cleaning compound such as DuPont White Polishing Compound®.

Note: To restore dull or scratched units: Apply white automotive polishing with a clean rag. Rub scratches and dull areas vigorously. Wipe off residue. Follow with a coat of white automotive paste wax.

 **DO NOT** wax areas where you walk or stand. For crack and major surface damage, call customer service at **1-800-221-3379** for repair recommendations.

Operating Instructions

1. Fill the bath to at least 3 inches above the jets before activating the pump. **DO NOT** turn on whirlpool unless jets are completely submersed in water.
2. The air bath blower and/or whirlpool pump is activated by pushing the control panel buttons (Provincetown and Bradenton system tubs air/whirlpool is turned on by depressing the actuator button). **DO NOT** repeatedly depress the switch in rapid order if you do not see the whirlpool function right away, as it may take a few seconds before you can see it fully operating. Please see air bath control or Total Massage Control instructions on the following page for operation and features.
3. If any factory installed fittings are removed; do not operate the unit. A safety hazard may occur.
4. Do not use bubble bath when you operate the whirlpool pump. This might cause excessive foaming.
5. Bath oils should not be used when you operate the whirlpool. If used while soaking, please drain and clean the tub thoroughly prior to activating the whirlpool system.
6. The use of bath salts is not recommended and doing so will **VOID THE CONSUMER'S WARRANTY**.
7. Both air and whirlpool systems are plumbed in a way that water will drain from the plumbing easily.
8. The air system is designed to purge within 20 minutes after use (see details on previous page).
9. There are no user serviceable parts located under the tub. If a problem develops, call 1-800-221-3379

Jet Operation and Adjustment

Mirabelle Sitka jets



The jets can be easily adjusted by pointing the jet-nozzle in the desired direction. The strength of the water flow and air induction can be regulated through twisting the jet- nozzle. Twisting the nozzle counter-clockwise will decrease the water flow of that particular jet. If the nozzle is twisted clockwise then the water flow will increase up to its maximum flow. Only a 1/4 turn or 90° turn is required from the lowest flow position to the fully OPEN position.

Mirabelle Boca Raton, Bradenton, Galatia, Key West, Provincetown and St. Augustine jets



The jets can be easily adjusted by pointing the jet-nozzle in the desired direction. The strength of the water flow and air induction can be regulated through twisting the jet- nozzle. Twisting the nozzle clockwise will decrease the water flow of that particular jet. If the nozzle is twisted counter-clockwise then the water flow will increase up to its maximum flow. Only a 1/4 turn or 90° turn is required from the lowest flow position to the fully OPEN position.

Whirlpool Control Center Features

Whirlpool

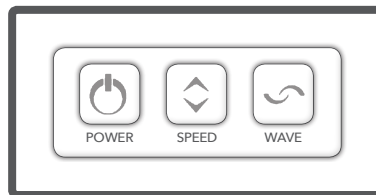

The whirlpool is controlled by a three button control.

1. The first button switches the water-pump on or off. The other features will not operate unless the pump is turned on.
2. The second button sets the power level of the pump. Holding the button depressed will cycle the pump power from low to high in a continuous cycle. When the desired level is reached, remove your finger quickly from the button to maintain that power setting.
3. The third button is a three step wave action button. Once activated, the jets expel water in a slow pulsating flow called wave action. There are 3 levels for wave strength.
 - a. **Level 1:** operates the pump at a steady flow.
 - b. **Level 2:** quick wave action.
 - c. **Level 3:** slower wave action.

Air Bath Control Center Features

Air

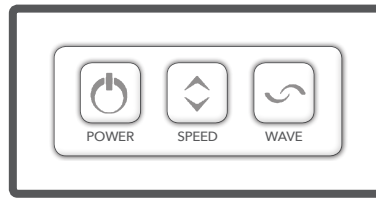

The air bath is controlled by a three button control.

1. The first button switches the blower on or off. The other features will not operate unless the blower is turned on.
2. The second button sets the power level of the blower. Holding the button depressed will cycle the blower power from low to high in a continuous cycle. When the desired level is reached, remove your finger quickly from the button to maintain that power setting.
3. The third button is a three step wave action button. Once activated, the air holes expel air in a slow pulsating flow called wave action. There are 3 levels for wave strength.
 - a. **Level 1:** operates the blower at a steady flow.
 - b. **Level 2:** quick wave action.
 - c. **Level 3:** slower wave action.

Total Massage Control Center Features

Total Massage

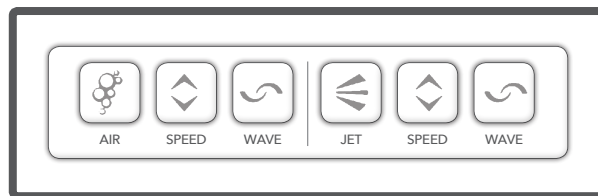

Total Massage units are a combination of whirlpool and air massages. The left three buttons on the control panel. Operate the whirlpool and the right three buttons operate the air system. The whirlpool and air massage systems may be used at the same time if desired. The whirlpool and air bath operations are explained in section above.

In-Line heater operation

If your unit has an in-line heater installed, operation is automatic only during the use of the whirlpool function. The in-line heater will maintain the water temperature only while the whirlpool is in operation.



Operating Instructions for Provincetown and Bradenton

Whirlpool baths: Equipped with on/off air switch actuator. Each depression of the switch will activate the pump. If off, one depression will turn the pump on. if on, the next depression will turn it off.

Air baths: Equipped with a three-speed air switch actuator. Each depression of the switch will change the flow of air. The forth depression will turn off the air pump.

Total message baths: Equipped with both an on/off air switch actuator for whirlpool function and three-speed air switch actuator for air function. See above for operation details.

Troubleshooting

PROBLEM	CAUSES	SOLUTION
Motor will not start	<ul style="list-style-type: none"> - Circuit breaker may be tripped - Lose/Bad wire connection - GFCI is tripped - Incorrect electrical installation - Jets are closed 	<ul style="list-style-type: none"> - Make sure it is a 20 Amp circuit breaker with nothing else tied to the circuit - Check for incorrect or lose wire connections, and pump/heater has been properly grounded - Reset if necessary - Insure each motor/ in-line heater uses its own 20 Amp circuit breaker and GFCI plug - Make sure that jets are fully operational and water is flowing
Motor overheating and cycling on and off	<ul style="list-style-type: none"> - Lose/Bad wire connection - Incorrect Amp usage - Air supply to motor 	<ul style="list-style-type: none"> - Check for incorrect or loose wire connections - Check for low voltage supply - Make sure motor gets fresh air supply and vents are not clogged
Pump/motor operates but jets/ air is not fully function	<ul style="list-style-type: none"> - Jets are closed - Suction/ strainer may be clogged - Air valves are closed 	<ul style="list-style-type: none"> - Open jets fully - With pump off, remove the suction cover/ strainer and remove any debris. - Open all air control valves
Motor makes humming noise but won't start	<ul style="list-style-type: none"> - Jets are closed - Pump does not have space to operate - Debris in pump - Incorrect Amp usage 	<ul style="list-style-type: none"> - Make sure jets are fully open - Make sure the motor shaft turns free - Check for jammed impeller or an obstruction on the (volute) casing. - Check for low voltage and undersized wire
Low water flow	<ul style="list-style-type: none"> - Clogged pipe - Incorrect electrical installation 	<ul style="list-style-type: none"> - Check for clogged plumbing lines - Check for low voltage
Water leaks	<ul style="list-style-type: none"> - Leak in the plumbing 	<ul style="list-style-type: none"> - Check compression fittings (union connections) making sure they are properly aligned and secured. Hand tighten only. Do not use any tools. - Make sure the o-ring is properly seated and not damaged.

FIVE-YEAR LIMITED WARRANTY

All Mirabelle Whirlpools and Bathing Systems are warranted in accordance with the following Limited Warranty: Mirabelle Whirlpools and Bathing Systems are warranted against defects in material and workmanship for a period of five (5) years from the date of the first consumer purchase. This Warranty shall apply to defective acrylic surfaces which crack, fade or blister, and any defect in whirlpool and bathing system components. The Warranty extends to the first consumer purchaser and not to subsequent owners, transferees or users other than the first purchaser. This warranty does not extend to products previously utilized as display models. This Warranty shall apply to products installed and used only for personal, family or household purposes and which are installed and maintained in accordance with Mirabelle Whirlpool and Bathing Systems' recommended installation and maintenance procedures. This Warranty does not extend to defects or damage caused, in whole or in part, by any unauthorized or unreasonable use. No liability shall exist for incidental or consequential damages caused in whole or part by any defects in Mirabelle Whirlpools and Bathing Systems. No warranty, expressed or implied, including any warranty of merchantability or fitness for a particular purpose, shall apply after the warranty period described above.

Some states do not allow the exclusion or limitation of incidental or consequential damages or limitations on how long an implied warranty lasts. The above limitation may not apply to you.

In the event of a defect in material or workmanship of a Mirabelle Whirlpool or Bathing System during the Warranty period, defective products will be repaired or replaced as Mirabelle, at its sole and absolute discretion, determines. However, Mirabelle shall not be liable for the expense for removing defective products or installing replacement products. In certain circumstances, some states do not allow the limitation of liability for removal, transportation and reinstallation expenses. The above limitation may not apply to you.

Only Mirabelle is authorized to perform its warranty obligation. If you wish to obtain performance of the Mirabelle warranty obligation you should contact Mirabelle, at (800) 221-3379. Other information about performance of the Mirabelle Whirlpool and Bathing Systems' warranty obligation may be obtained at the same address and telephone number. This Warranty gives you specific legal rights and you may also have other rights which vary from state to state.

Cut-Out Templates

INSTALLING AN OVAL TUB WITH A TEMPLATE

The back section of the installation manual contains oval cut out instructions. Use pencil and tape measure to plot the coordinates and draw the cut out. Take special care to place tub carefully in the platform cutout, because the tub might break and the ensuing warranty limitations would become void. For additional questions on installing your tub read "installation procedures" above or call customer service at 800-221-3379.

Mirabelle Cut-Out Template
Use for Boca Raton 7242

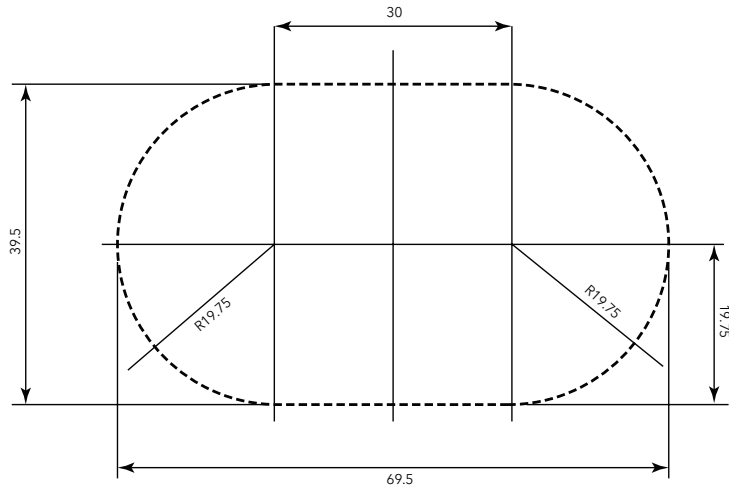

Mirabelle Cut-Out Template
Use for Boca Raton 6640

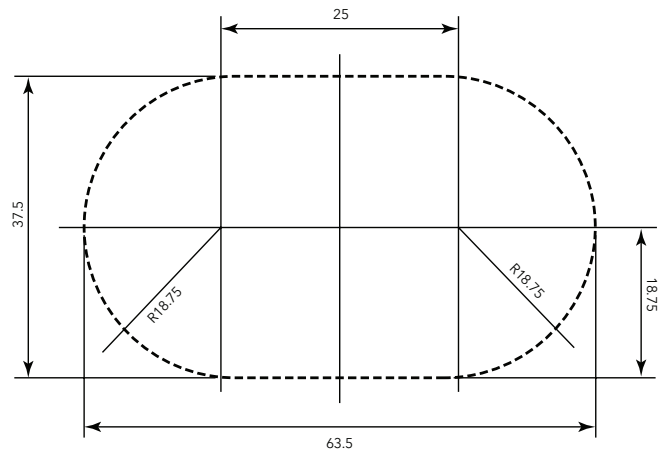

Cutout for Galatia Tubs

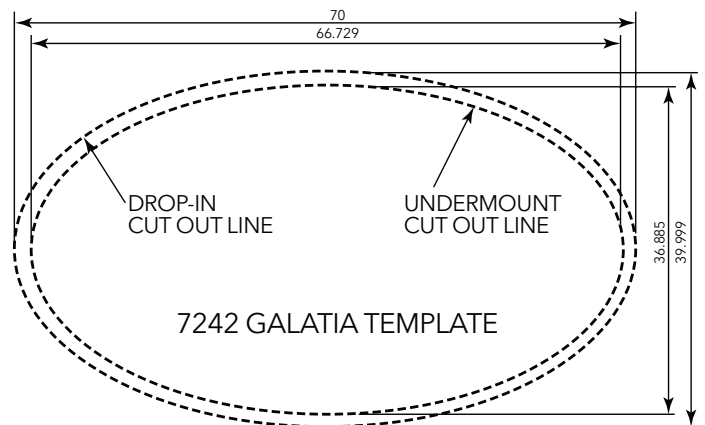
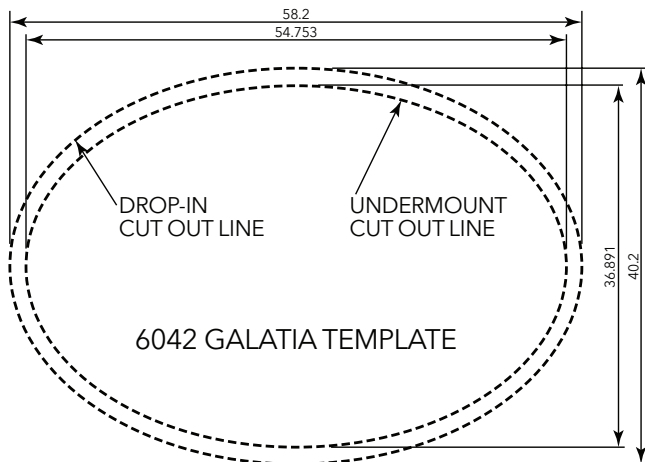

Mirabelle®

www.mirabelleproducts.com